

GLASS DOOR HINGE

⚠ Read all instructions carefully for proper installation.

■ Construction

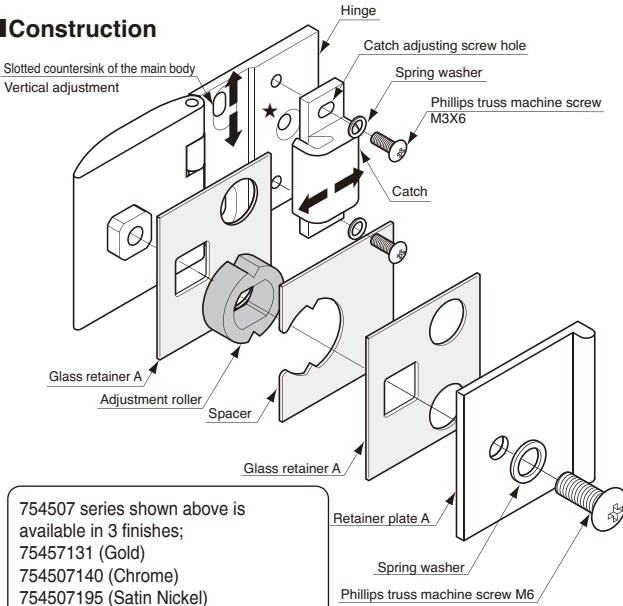

754507 series shown above is available in 3 finishes;
 75457131 (Gold)
 754507140 (Chrome)
 754507195 (Satin Nickel)

Glass processing drawing (Unit: mm)

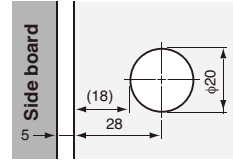

754507 series Side glass hole processing

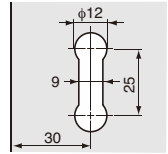

■ Number of spacers used for each glass

5mm thick glass	6mm thick glass	8mm thick glass
3 pieces	2 pieces	Not used.

■ Hinge installation

- 1 Prepare both panels of glass according to the processing shown above.
- 2 Referring to the illustration above, assemble the parts, and securely fasten the glass door with the Phillips truss machine screw M6. (Note that the number of spacers is different depending on the thickness of the glass door.)
 - Adjustment of glass door
 - Vertical adjustment : Loosen the screw in two slotted countersinks of the main body and vertically slide the hinge. (Adjustable allowance: Vertically 2mm)
 - Horizontal adjustment : Loosen the Phillips truss machine screw M6, and horizontally slide the glass for adjustment. (Adjustable allowance: Horizontally 2.5mm)