

Glass Mount Fixed Bracket

Code No.: SSZH1071116170

- For Glass 10 – 13.52mm (3/8" – 1/2") – With Supplied M8 x 20.
- Longer Internal Screws Can Accommodate Thicker Glass
- Hole Fabrication 19mm (3/4")

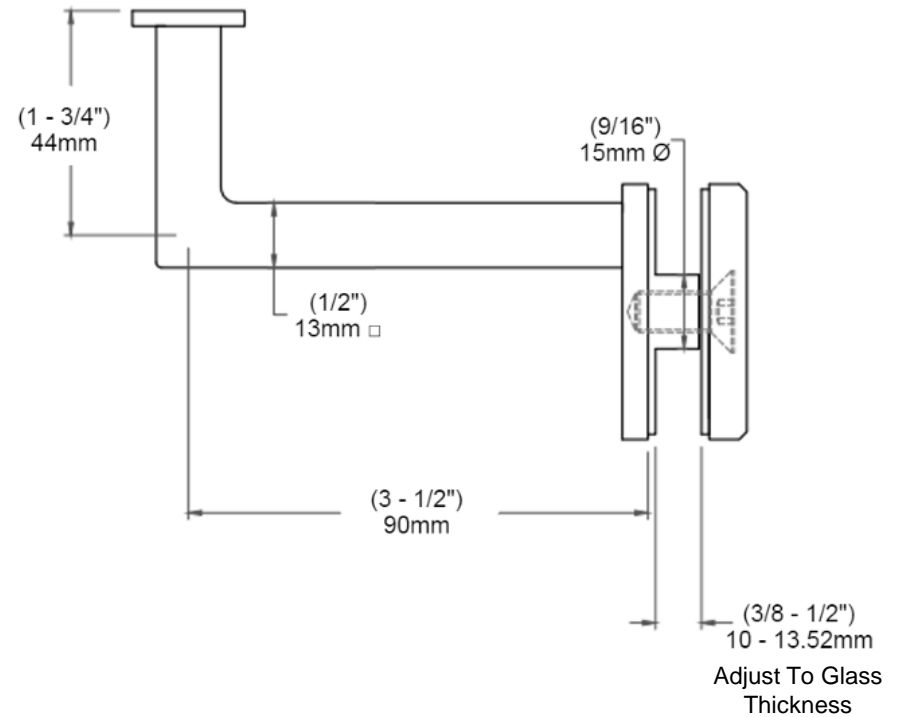
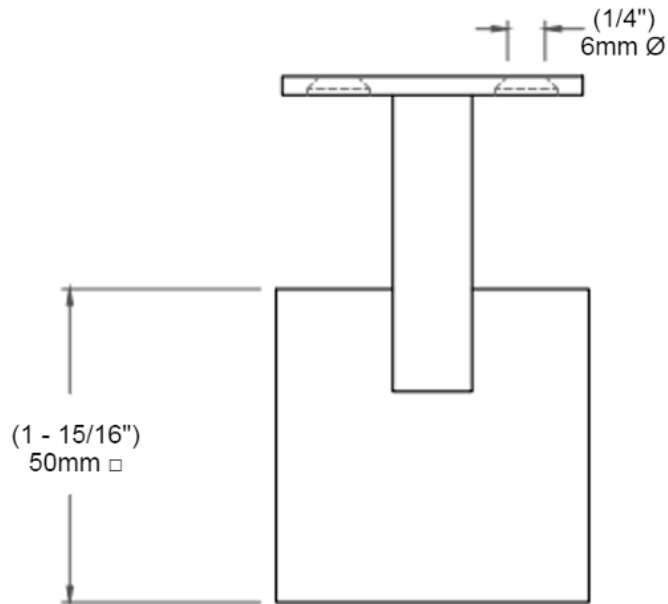

Code No.: SSZH1071116170

- Pour verre 10 – 13.52mm (3/8" – 1/2") – avec M8 x 20.
- Des vis internes plus longues peuvent s'adapter à des verres plus épais
- Fabrication de trous 19mm (3/4")

